

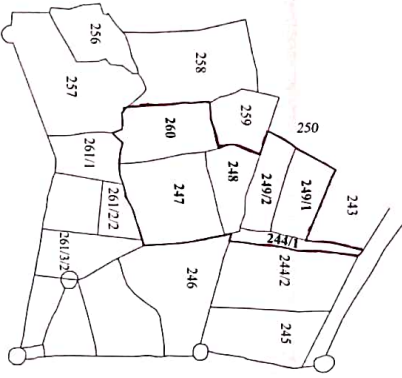

GOOGLE MAP
Scale - N.T.S

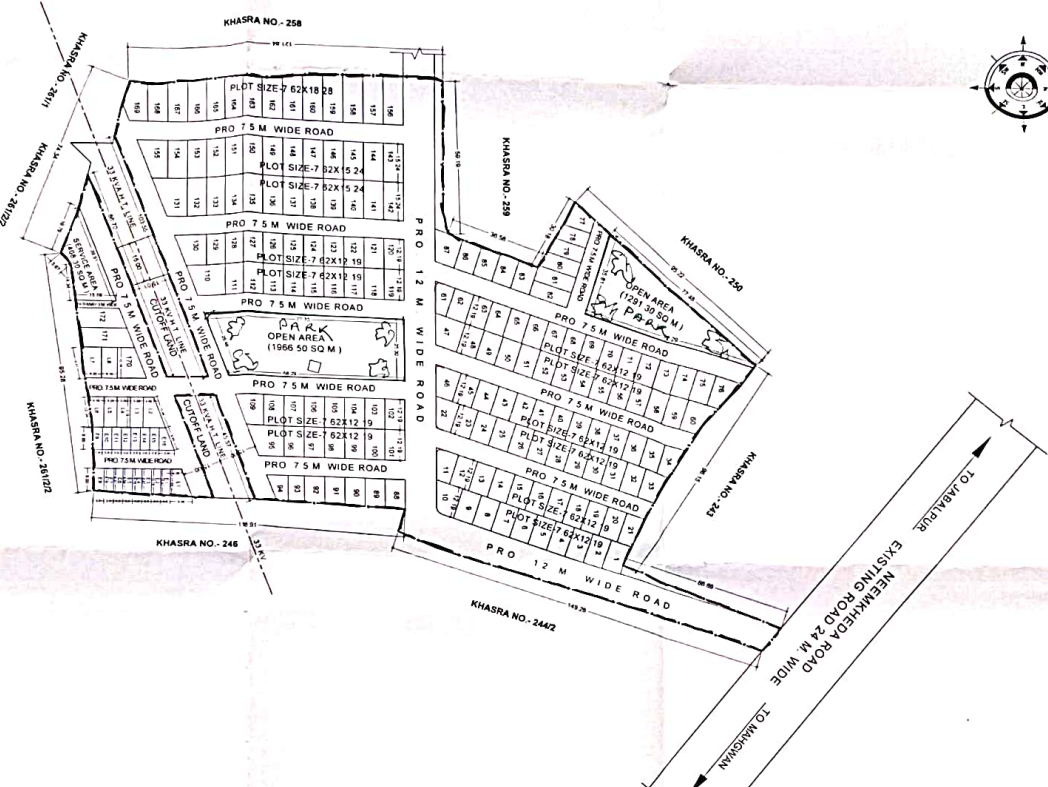

KHASRA MAP
Scale - 1:4000

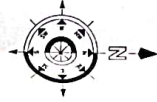

LAYOUT PLAN
Scale - 1:1000

AREA DETAILS OF EWS & LIG.	SALEABLE AREA @ 6% = 1105.20 SQ M	LIG 3% REQUIRED AREA = 552.60 SQ M
PLLOT NO.	SIZE (METER)	AREA (SQ.M)
LIG-1	4.28X10.87	68.89
LIG-2	4.00X12.19	77.70
LIG-3	5.00X12.19	61.00
LIG-4	5.00X12.19	61.00
LIG-5	6.18X12.19	63.40
LIG-6	6.20X12.19	87.20
LIG-7	6.10X12.19	74.96
PROVIDED AREA OF LIG = 553.86		
EWS 3% REQUIRED AREA = 552.60 SQ M		
EWS-1	3.60X9.00	37.20
EWS-2	3.60X10.41	37.20
EWS-3	3.60X9.00	32.50
EWS-4	3.60X9.00	32.50
EWS-5	3.60X9.00	32.50
EWS-6	3.60X9.00	32.50
EWS-7	3.60X9.00	32.50
EWS-8	3.60X9.00	32.50
EWS-9	3.60X9.00	32.50
EWS-10	3.60X9.00	32.50
EWS-11	3.60X9.00	32.50
EWS-12	3.60X9.00	32.50
EWS-13	3.60X9.00	32.50
EWS-14	3.60X9.00	32.50
EWS-15	3.60X9.00	32.50
EWS-16	3.60X9.00	32.50
PROVIDED AREA OF EWS = 552.72		

Checked and signed by
R. H. PATIL
Sub Engineer

... (Official stamp and text in Hindi) ...



STATEMENT OF AREA	
PARTICULAR	AREA (SQ M)
TOTAL LAND AREA	35100.00
CUTOFF LAND AREA	2553.00
NET PLANNING AREA	32575.00 (3.2575 HEC)
PLANTABLE AREA	18420.00
OPEN AREA	3257.50
ROAD AREA	10490.50
SERVICE AREA	407.00
TOTAL SALEABLE AREA	18420.00 SQ M
SALEABLE AREA @ 6%	1105.20 SQ M
LIG 3% REQUIRED AREA	552.60 SQ M
EWS 3% REQUIRED AREA	552.60 SQ M

STATEMENT OF AREA	
PROPOSED RESIDENTIAL PLOTTED LAYOUT PLAN	AT N - 209, P. H. No-77, KHASRA No-244/1, 247, 248, 249/1, 249/2 & 260 AT MALZIJA PIPARIYA KHURO, MAHAGWANI, R.N.M. KHAMHARSIYA, TEH & DISTRICT JABALPUR (M.P.)
PROJECT	"SHREE MAHAMAAYA PARISAR"
DEVELOPER	SHREE MAHAMAAYA ASSOCIATES

OWNER: :-
1-Shri SANTOSH CHOUBEY
S/o Late Shri JAWAHAR LAL CHOUBEY
2-Shri TARUN PALI
S/o Late Shri SHYAM LAL PALI
3-Shri BHAGWAN SINGH
S/o Late Shri GOVIND SINGH
4-Shri ASHOK JAISWAL
S/o Late Shri SHEETAL PRASAD JAISWAL
5-Shri PARUL JAISWAL
S/o Shri ASHOK JAISWAL

ARCHITECT/PLANNER
R.H. PATIL
Sub Engineer

SCALE 1:1000
OWNER SIGNATURE
DATE

RAMJE ASSOCIATES ARCHITECTS & PLANNERS INTERIOR DESIGNERS
Plot No. 244/1, 247, 248, 249/1, 249/2 & 260, Malziya Pipariya Khuro, Mahagwani, R.N.M. KhamharSIYA, Teh & District Jabalpur (M.P.)
M: 91599210155 & 91949292724
W: www.ramjeassociates.in